

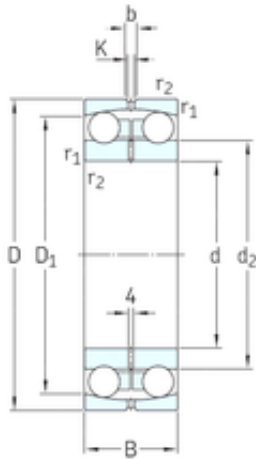

GQ (Xiamen) Bearing Co., Ltd.



220 mm x 300 mm x 60 mm SKF 13944 self aligning ball bearings

Bearing No. 13944

13944 Bearing 2D drawings and 3D CAD models

Size	220x300x60 mm
Bore Diameter	220 mm
Outer Diameter	300 mm
Width	60 mm
d	220 mm
D	300 mm
B	60 mm
C	60 mm
b	8,3 mm
d2	249 mm
r1 min.	2,1 mm
r2 min.	2,1 mm
D1	278 mm
K	4,5 mm
da min.	231 mm
Da max.	289 mm
ra max.	2 mm
Weight	11 Kg
Basic dynamic load rating (C)	60,5 kN
Basic static load rating (C0)	30,5 kN
Fatigue load limit (Pu)	0,97
Reference speed	3800 r/min
Limiting speed	2400 r/min
Calculation factor (e)	0,18
Calculation factor (kr)	0,015



GQ (Xiamen) Bearing Co., Ltd.

Calculation factor (Y0)	3,6
Calculation factor (Y1)	3,5
Category	Self Aligning Ball Bearings
Inventory	0.0
Manufacturer Name	SKF
Minimum Buy Quantity	N/A
Weight / Kilogram	11.94
EAN	7316571591339
Product Group	B00152
Mounting Method	Shaft
Enclosure	Open
Rolling Element	Ball Bearing
Cage Material	Steel
Precision Class	ABEC 1 ISO P0
Internal Clearance	C0-Medium
Number of Rows of Balls	Double Row
Other Features	Allowable Misalignment 3 Deg
Long Description	220MM Bore; Shaft Mount; 300MM Outside Diameter; 60MM Inner Race Width; 60MM Outer Race Width; Open; Steel Cage; Double Row of Balls; ABEC 1 ISO P0; C0-Medium
Inch - Metric	Metric
Category	Self Aligning Ball Bearings
UNSPSC	31171532
Harmonized Tariff Code	8482.10.50.68
Noun	Bearing
Keyword String	Self Aligning
Manufacturer URL	http://www.skf.com
Manufacturer Item Number	13944
Weight / LBS	26.296



GQ (Xiamen) Bearing Co., Ltd.

Bore	8.661 Inch 220 Millimeter
Inner Race Width	2.362 Inch 60 Millimeter
Outside Diameter	11.811 Inch 300 Millimeter
Outer Race Width	2.362 Inch 60 Millimeter
d_1	248.9 mm
D_1	277.8 mm
$r_{1,2}$ min.	2.1 mm
d_a min.	231 mm
D_a max.	289 mm
r_a max.	2 mm
Basic dynamic load rating C	60.5 kN
Basic static load rating C_0	30.5 kN
Fatigue load limit P_u	0.97 kN
Permissible angular misalignment	3 °
Calculation factor k_r	0.015
Calculation factor e	0.18
Calculation factor Y_0	3.6
Calculation factor Y_1	3.5
Calculation factor Y_2	5.4
Mass bearing	11 kg